



11 Portland Road

, Gillingham, ME7 2NP

Offers Over £200,000



MMS are offering to the market CHAIN FREE and in need of modernising, this 3 SEPARATE BEDROOM period house. This would be an ideal home for the DIY enthusiast and gives you a property you can really put your own stamp on. Accommodation comprises of an entrance hallway, lounge, dining room, kitchen, lobby area, lean-to and bathroom. The first floor houses the 3 separate well proportioned bedrooms. The property also boasts CELLAR ROOMS and a rear garden. This is ideally located for the town centre, train station and local amenities. Council tax band B. EPC rating D.



Porch

Hallway

Lounge

Dining Room

Kitchen

Laundry Room

Bathroom

Lean-To

Master Bedroom

Bedroom Two

Bedroom three

Landing

Rear Garden

Area Map



Floor Plans

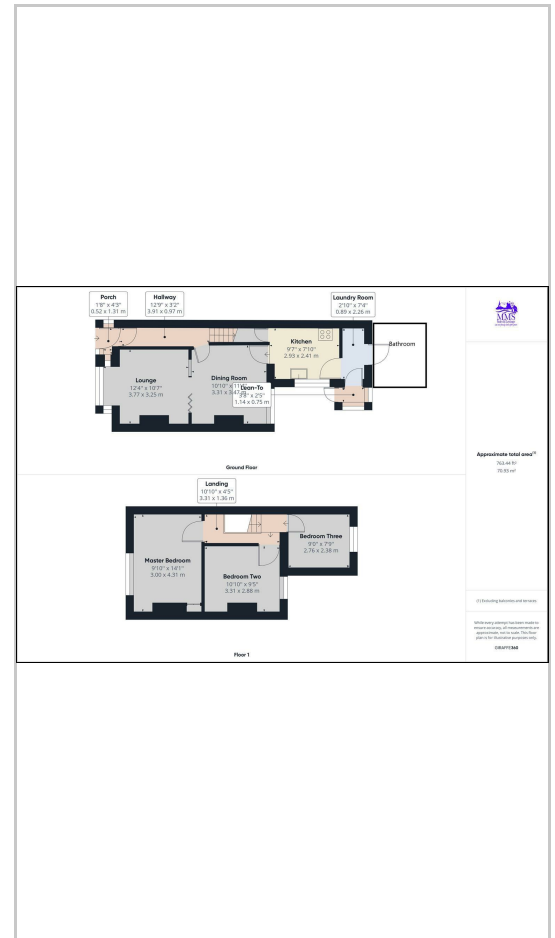

Energy Efficiency Graph

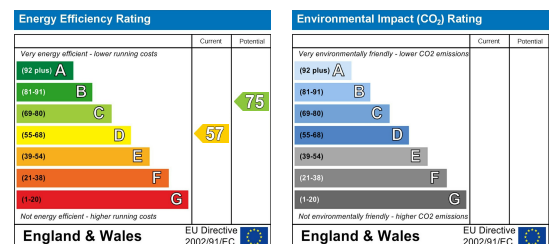

These particulars, whilst believed to be accurate are set out as a general outline only for guidance and do not constitute any part of an offer or contract. Intending purchasers should not rely on them as statements of representation of fact, but must satisfy themselves by inspection or otherwise as to their accuracy. No person in this firm's employment has the authority to make or give any representation or warranty in respect of the property.

159 High Street, Strood, Rochester, Kent, ME2 4TH

Tel: 01634 735335 Email: justine@medwaymortgageshop.co.uk <https://www.medwaymortgageshop.co.uk>